

Booking Conditions

1. The person signing the booking form must ensure the party is as stated and must inform Sandown Bay Chalet Rentals of any changes on or before arrival. The hirer accepts responsibility for the conduct of the party and for any unreasonable damages.
2. On arrival a **£30 cash Bond** is payable to cover lost keys, unreturned linen, unreasonable damage and unclean chalets. Any faults or shortages to the chalets must be reported immediately. The hirer is responsible for ensuring that the chalet is left clean and tidy as found, and agrees to reimburse the owner for any loss, damage, or unnecessary cleaning at the end of the hire period. The bond will be returned on satisfactory check out on the day of departure. The company reserve the right to charge £5 per half hour for departure after the 10am deadline (other than by prior arrangement).
3. A **£75** deposit per week booked (non refundable) must be made with the booking. The balance must be paid **8 weeks** prior to holiday start date. Cheques & Postal Orders made payable to **Mr J M Baker and sent to 20-22 St. Richard's Road, Walmer, Deal, Kent CT14 9JR**. When you make your booking and we have received the required deposit to secure the booking, a legally binding contract exists between us that is non-cancellable and non-refundable, except in exceptional circumstances. You may still remain liable to pay in full or in part for the booking, even if you are unable to take your holiday. Even where you have not paid in full at the time of cancellation, you will remain liable for the full cost. If for some reason you do not need to cancel, it is important that you tell us at the first opportunity so that we may attempt to re-let your chalet and minimise your loss. You should take out cancellation insurance to protect against your possible loss.
4. We would only cancel your holiday if your accommodation was unavailable for reasons beyond our control. We would, however, attempt to offer you alternative accommodation. If this was not possible or unacceptable to you, then we would refund all monies paid by you for the holiday. Except in exceptional circumstances, our liability would not extend beyond this refund.
5. Vehicles: the 10mph site speed limit must be observed and vehicles must only be driven by insured licence holders, who will be responsible for any injury or damage to persons and property. Parking must be in designated areas only and not on the grass. Parking is close to all of our chalets with the exception of chalet 178 which is tucked away in a quiet and secluded location on the site.
6. We regret that pets are only permitted in certain chalets and the appropriate fee must be paid - £40.00 per pet per week or part week. Owners of pets remain fully responsible at all times for the welfare of their pets and for clearing up after them fully and for ensuring that their pets do not cause any offense or problems for other holiday makers such as excessive barking and that dogs remain on a lead at all times when out of the chalets and that they are NEVER left in the chalets without their owners being present.
7. Specific chalets or facilities cannot be guaranteed but we will endeavour to meet your requirements.
8. Waterproof sheets are available from our reception upon request and failure to protect the bedding will render the hirer liable for the replacement cost.
9. The hirer is responsible for reporting any contact with infectious diseases by any member of his/her party prior to or during the holiday dates.
10. Barbecues are allowed in certain areas subject to prior consultation.
11. We reserve the right to withdraw any advertised amenity or facility without prior notice.
12. As per current UK legislation on Smoking, NO SMOKING is permitted in any of our chalets.
13. All breakages must be report to our reception so that replacements can be ordered/provided as quickly as possible, we reserve the right to charge for all breakages.
14. There is an Access Statement available on request from the proprietors for the chalets.

Owners:- Mr J Baker & Mr J McDonald

20-22 St. Richard's Road, Walmer, Deal, Kent CT14 9JR

Telephone: (01304) 368657 or 07850 985249



Go to the Home Page of our website at:- www.sandownbay.com and click on the Wheelchair logo to download our "Access Statement"



**PRICES
HELD AS
2014**



Book now and start enjoying a relaxing holiday on the tranquil Isle of Wight at Sandown Bay Holiday Centre, set in an area of outstanding natural beauty.

 2014/15 Member	 SELF CATERING		 Member 2014/15	Sandown Business Association Member
--	--	---	--	--

**We are able to take
payments for your
chalet booking by:-**



Map of UK



Travel to the Isle of Wight

	<p>Wight Link Ferries Telephone: 0870 582 7744 www.wightlink.co.uk</p>
	<p>Red Funnel Telephone: 0844 844 9988 www.redfunnel.co.uk</p>
	<p>Hover Travel Telephone: 01983 811000 www.hovertravel.co.uk</p>

Map of Isle of Wight

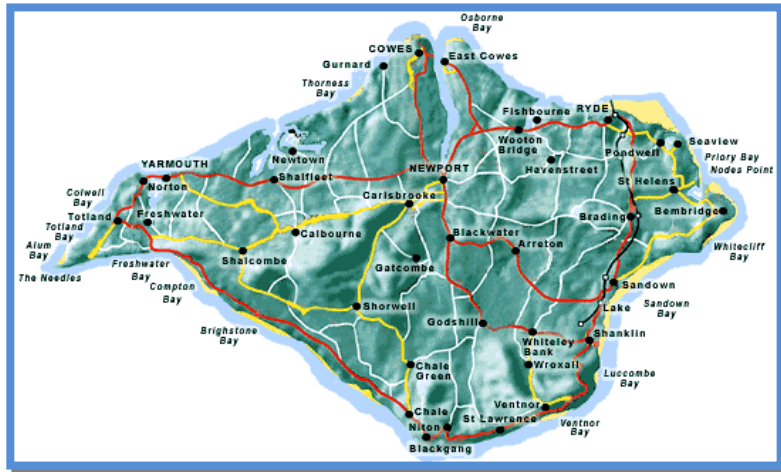

Aerial Map of Sandown



Attractions

	<p>Set in Over 40 acres of spectacular cliff-top gardens - you will find a magical mix of fantasy, legend and heritage! Telephone: 01983 730330 www.blackgangchine.com</p>
	<p>The Islands favourite countryside attraction with something for everyone. The Islands biggest rides, loads of children's play features and areas of space to run free. Telephone: 01983 730052 www.robin-hill.com</p>
	<p>Set in an area of outstanding natural beauty overlooking The Needles Rocks and Lighthouse, a spectacular chairlift past amazing coloured sand. Telephone: 0870 4580022 www.theneedles.co.uk</p>
	<p>Step into Queen Victoria's country home, experience a world unchanged since the country's longest reigning monarch died here over 100 years ago. Telephone: 01983 200022 www.english-heritage.org.uk/</p>
	<p>This is not a large zoo but it does specialise in Tigers, Lions, Jaguars, Panthers and Black Leopards - accompanied by reptiles, small animals, birds and some monkeys. Keeper talks. Telephone: 01983 403883 www.isleofwightzoo.com</p>
	<p>Registered charity rescuing donkeys in need. Over 200 donkeys and other animals enjoy a permanent home in 50 acres. Telephone: 01983 852693 www.iwdonkey-sanctuary.com</p>
 <p>This is a mystery tour with a difference based in the perfectly ghostly setting of night time. Telephone: 01983 520695 www.ghost-tours.co.uk</p>	 <p>Family Ice skating at Ryde on the Isle of Wight, with lots of special events. Tel: 01983 615 155 www.planet-ice.co.uk</p>

Introduction



Sandown Bay Holiday Centre is situated on a site which was originally a fort, built during the Napoleonic Wars to protect Sandown and the Channel.

The cliffs and shore border the grounds with beautiful views over the English Channel on one side and the green rolling Culver Down on the other.

Sandown Bay Holiday Centre is an ideal location from which to explore the island whether you travel by car, train, bus cycle or shank's pony. Within Sandown & Shanklin you will find the nearest shops (10-15 minute walk downhill), indoor pool, leisure facilities and everything you would expect to find in a traditional seaside town and to complete our picture, Sandown has one of the highest sunshine records in England. There is a bus service which stops not far from the entrance to the site.

We own seven chalets available to holiday makers, we hope you enjoy staying on the site as much as we and our family and friends do.

TARIFF FOR 2015

Nights	March 7th to March 28th	March 28th to April 18th (Easter)	April 18th to July 11th	July 11th to Aug 29th	Aug 29th to Sep 5th	Sep 5th to Jan 2nd	Xmas/New Year Tue to Tue
7 nights Sat to Sat	185.00	277.50	220.00	465.00	277.50	220.00	185.00
Mon – Fri	138.75	208.50	165.00	348.75	208.50	165.00	138.75
Fri - Mon	111.00	166.50	132.00	279.00	166.50	132.00	111.00
Extra Nights	37.00	55.50	44.00	93.00	55.50	44.00	37.00

(Minimum booking 3 nights)

Dogs add £40.00 per week

Cots £10.00 per week - High Chair £10.00 per week

	Low Season		Mid Season
	Off Peak		Peak Season

Prices are PER CHALET and INCLUDES LINEN

You just need to bring your own Towels and T-towels

Minimum of £75 per week deposit required when making your booking.

Electricity (240v) is by prepayment key located outside each chalet in the electric box, a reading is taken on arrival and on departure, you only pay for what you have used, water is mains water and is not stored in any tanks etc.

The views overlooking the cliffs edge are outstanding, the bay is a sandy beach that is ideal during the hot summer holidays.



The Site is situated in an Area of "Outstanding Natural Beauty"



There is a coin operated launderette provided on the site by the site management.

Chalet Facilities

	21	22	26	27	84	85	178
Visit England Grading	3*	3*	3*	3*	3*	3*	3*
Full Kitchen	✓	✓	✓	✓	✓	✓	✓
Cooker & Hob	✓	✓	✓	✓	✓	✓	✓
Microwave	✓	✓	✓	✓	✓	✓	✓
TV	✓	✓	✓	✓	✓	✓	✓
Video or DVD Player	✓	✓	✓	✓	✓	✓	X
CD/Radio	✓	✓	✓	X	X	X	X
Freeview Digital TV	✓	✓	✓	✓	✓	✓	✓
Bedrooms	2	2	2	2	2	2	2
Double Bed	2	2	2	2	2	2	2
Single Bunks	1	1	1	1	1	1	1
Sleeps	6	6	4/5*	6	6	6	7
Shower	✓	✓	✓	✓	✓	✓	✓
Bath	✓	X	X	X	X	X	✓
Iron & Ironing Board	✓	✓	✓	✓	✓	✓	✓
Electric Heaters	✓	✓	✓	✓	✓	✓	✓
Pets Allowed	✓	✓	✓	X	✓	✓	X

- Sleeps four in bedrooms and there is a large corner sofa that can sleep one person but this is not a proper sofa bed.



Whilst we welcome dogs to bring their owners away with them on holiday in some of our chalets you must remain responsible for your owners to clear up after you and that they dispose of any "faeces" properly so as not to annoy or interrupt any other holiday makers on the site, this includes excessive barking etc. Please remind your owners also that you must remain on a lead at all times whilst out of the chalet on the site and that you must never be left alone in the chalets!

Typical Floor Plan of our Chalets

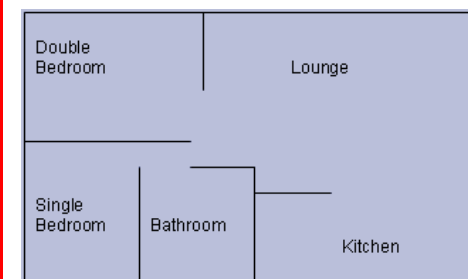

Car Parking, whilst there is more than sufficient parking on the site, they are not designated for each chalet so parking is on a first come first served basis